





**** BEAUTIFUL GARDEN
AND PLOT **** NO CHAIN

**** This is a lovely
opportunity to purchase a
three bedroom semi
detached property in the
highly regarded village of
Aston on Trent. In brief the
property offers a hall,
lounge with fireplace, dining
room and a fitted kitchen.

Three bedrooms and a
shower room, front and rear
gardens, long drive and a
single garage.



ABODE
SALES & LETTINGS

HALL

Entrance door into the hall with stairs to the first floor, storage cupboard, radiator and door to -

LOUNGE

Feature fireplace with marble effect insert and hearth and a wood surround. Radiator, upvc double glazed window to the front and a door to the dining room.

DINING ROOM

Under stairs storage cupboard, radiator, upvc double glazed window to the rear and a door to the kitchen.

KITCHEN

Fitted wall mounted, base and drawer units with work surfaces and a sink and drainer unit. Fitted electric oven and a gas hob, plumbing and space for a washing machine and space for a fridge freezer. Radiator, upvc double glazed window to the rear and a door to the side.

FIRST FLOOR LANDING

Airing cupboard, loft access and doors to -

BEDROOM 1

Fitted wardrobes, cupboards and dressing table, radiator and upvc double glazed window to the front.

BEDROOM 2

Upvc double glazed window to the rear and a radiator.



BEDROOM 3

Storage cupboard, radiator and upvc double glazed window.







BATHROOM

Enclosed shower, low flush wc, wash hand basin, radiator and upvc double glazed window.

OUTSIDE

Front lawn and a long drive down to a single garage. gated access to the rear garden offering a lawn with mature borders and shrubs, paved patio.



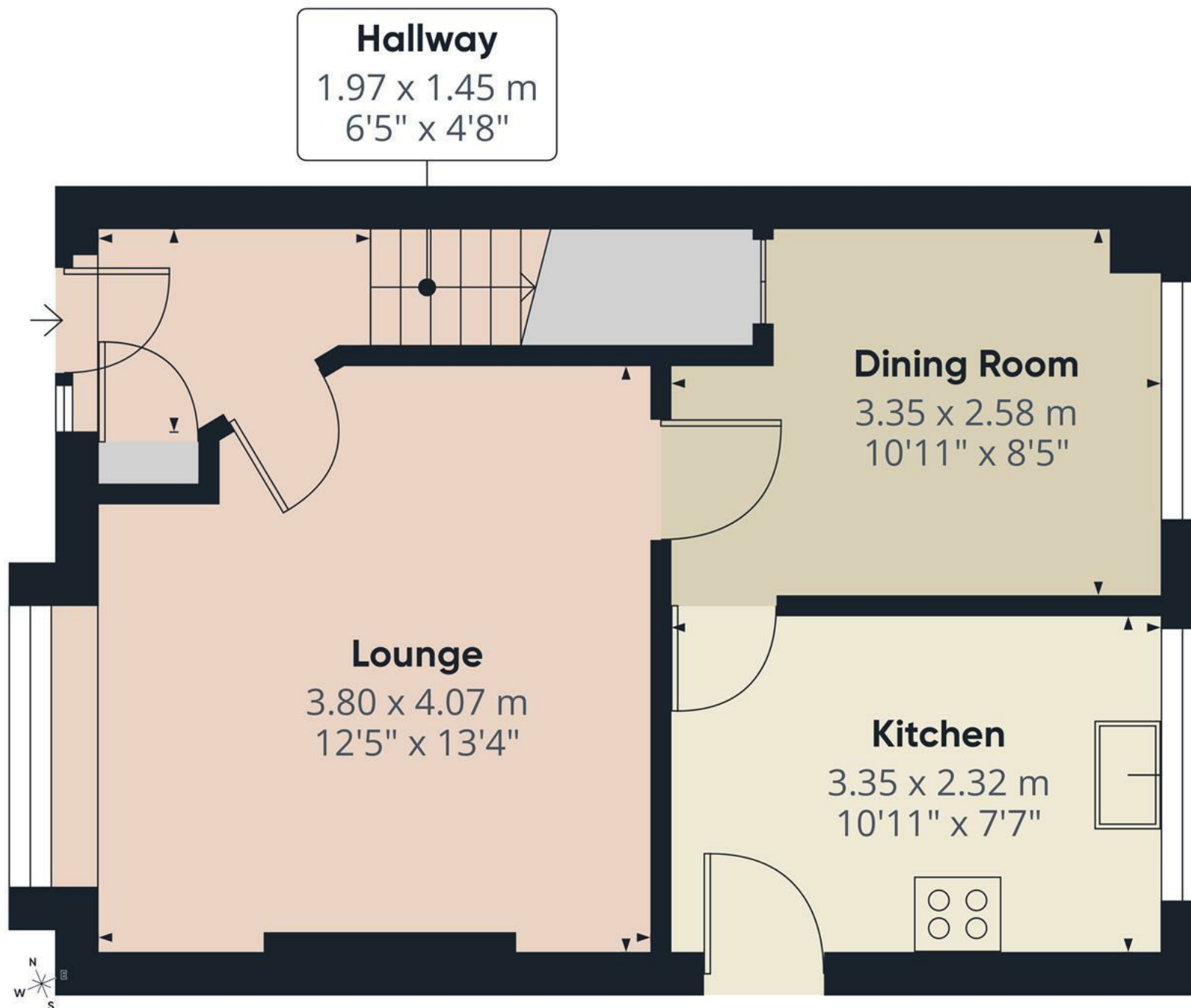

Floor 0

Approximate total area⁽¹⁾

35.8 m²

385 ft²

(1) Excluding balconies and terraces

Calculations reference the RICS IPMS 3C standard. Measurements are approximate and not to scale. This floor plan is intended for illustration only.

GIRAFFE360

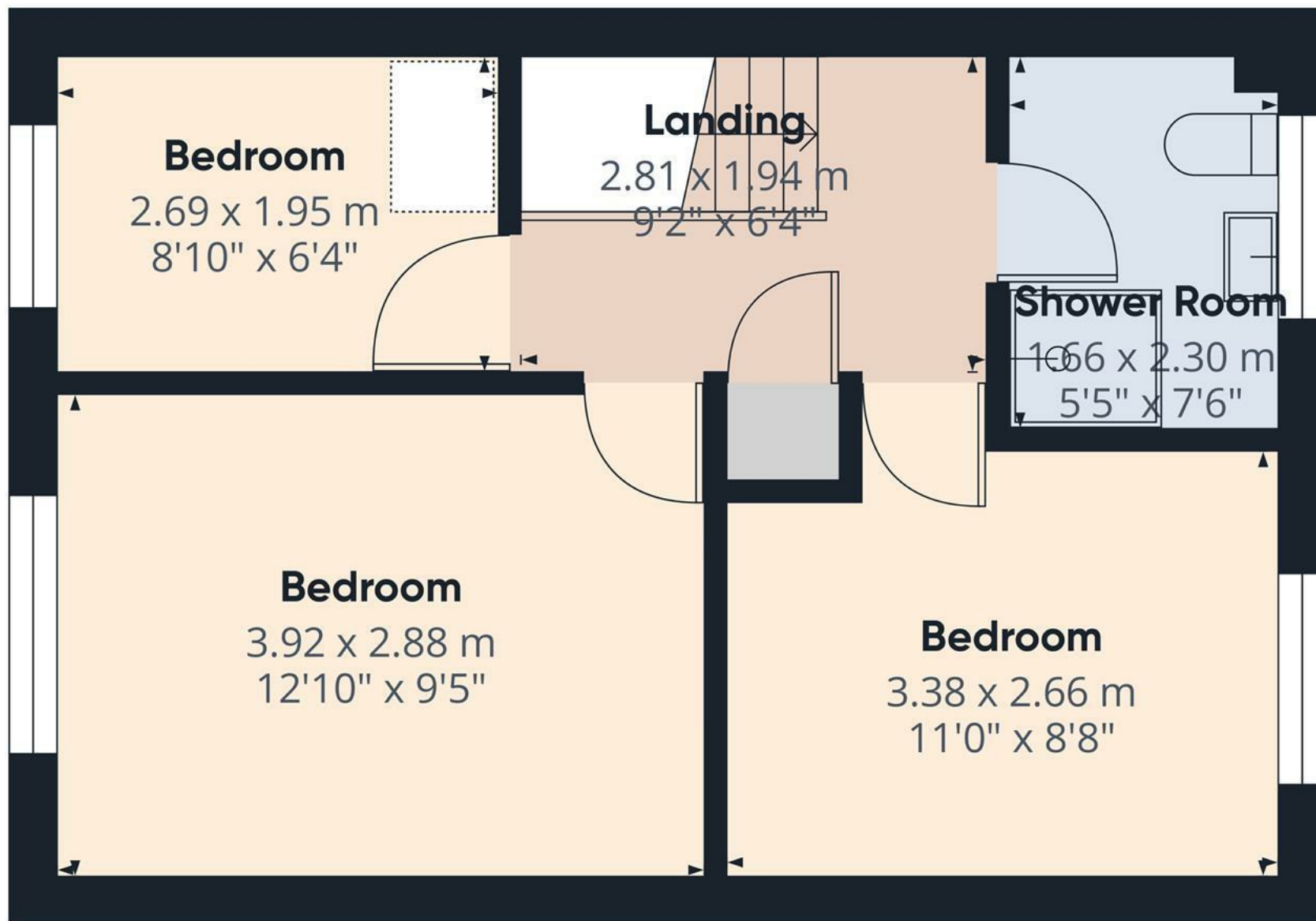

Approximate total area⁽¹⁾
32.8 m²
354 ft²

(1) Excluding balconies and terraces

Calculations reference the RICS IPMS 3C standard. Measurements are approximate and not to scale. This floor plan is intended for illustration only.

GIRAFFE360



Floor 1

